

Alon Town Centre

Mixed-Use Development in North San Antonio

NW Military Hwy and Wurzbach Parkway



10003 NW Military Hwy, Suite #2205
San Antonio, TX 78231

t 210.593.0777
f 210.593.0780

www.fulcrumsa.com

fulcrum
DEVELOPMENT

Alon Town Centre

Mixed-Use Development in North San Antonio

Location:

SWC of Wurzbach Pkwy &
NW Military Hwy | San Antonio, TX

First Floor Retail/Office:

- 3,129 SF

Rates:

Contact Broker

Property Description:

Alon Town Centre is a 330,000 square foot mixed-use retail and office development in the heart of the affluent North Side of San Antonio, Texas. Alon Town Centre is anchored by HEB's Alon Market, one of their most unique grocery concepts. The development includes a collection of distinctive shops, restaurants, and cafes in an urban retail village setting.



Demographics	1 mile	3 mile	5 mile
Population	12,371	108,722	271,012
Households	5,487	47,494	116,418
Avg HH Income	\$90,150	\$81,759	\$75,320

Current Tenants:



10003 NW Military Hwy, Suite #2205
San Antonio, TX 78231

t 210.593.0777
f 210.593.0780

www.fulcrumsa.com

fulcrum
DEVELOPMENT

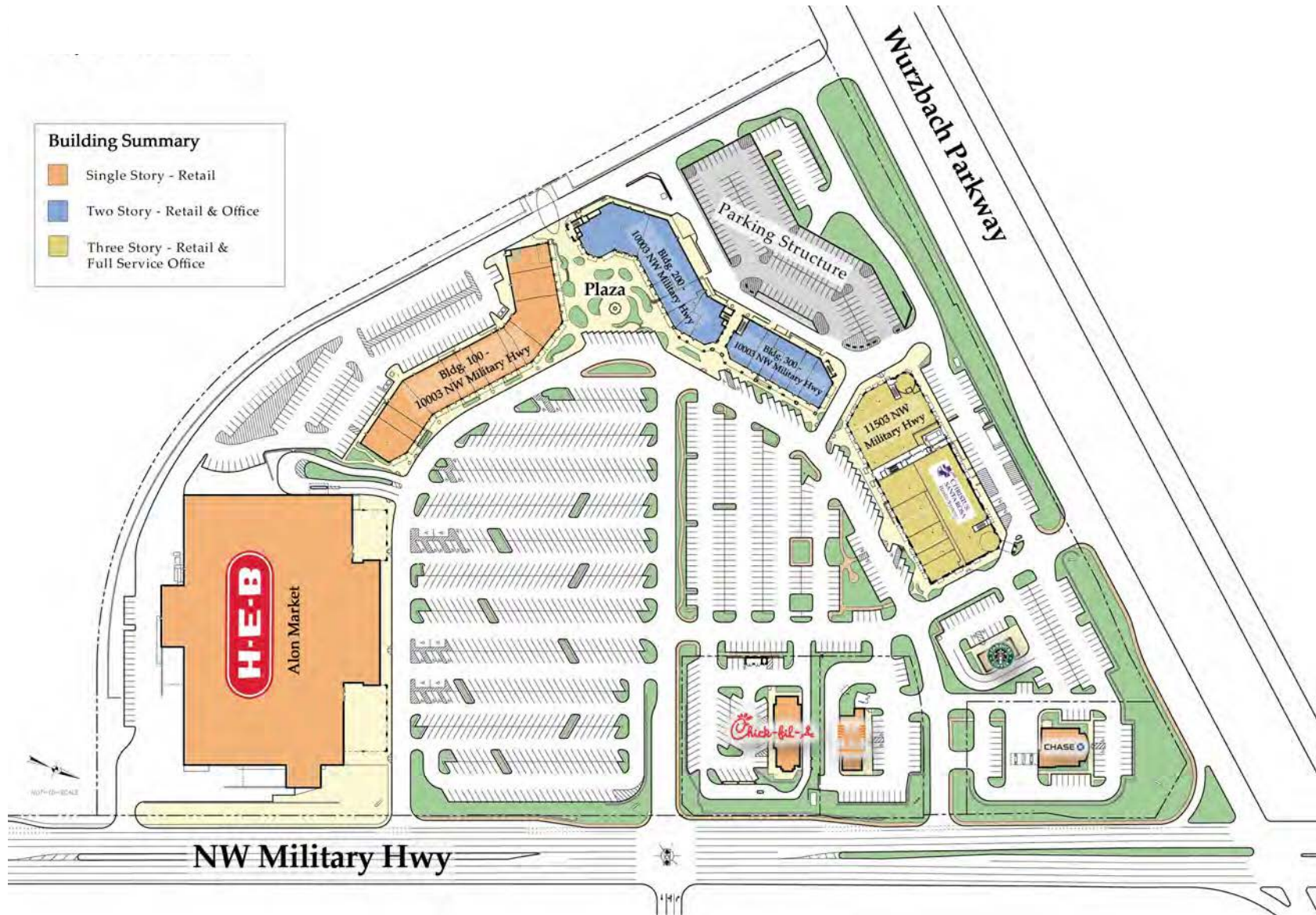

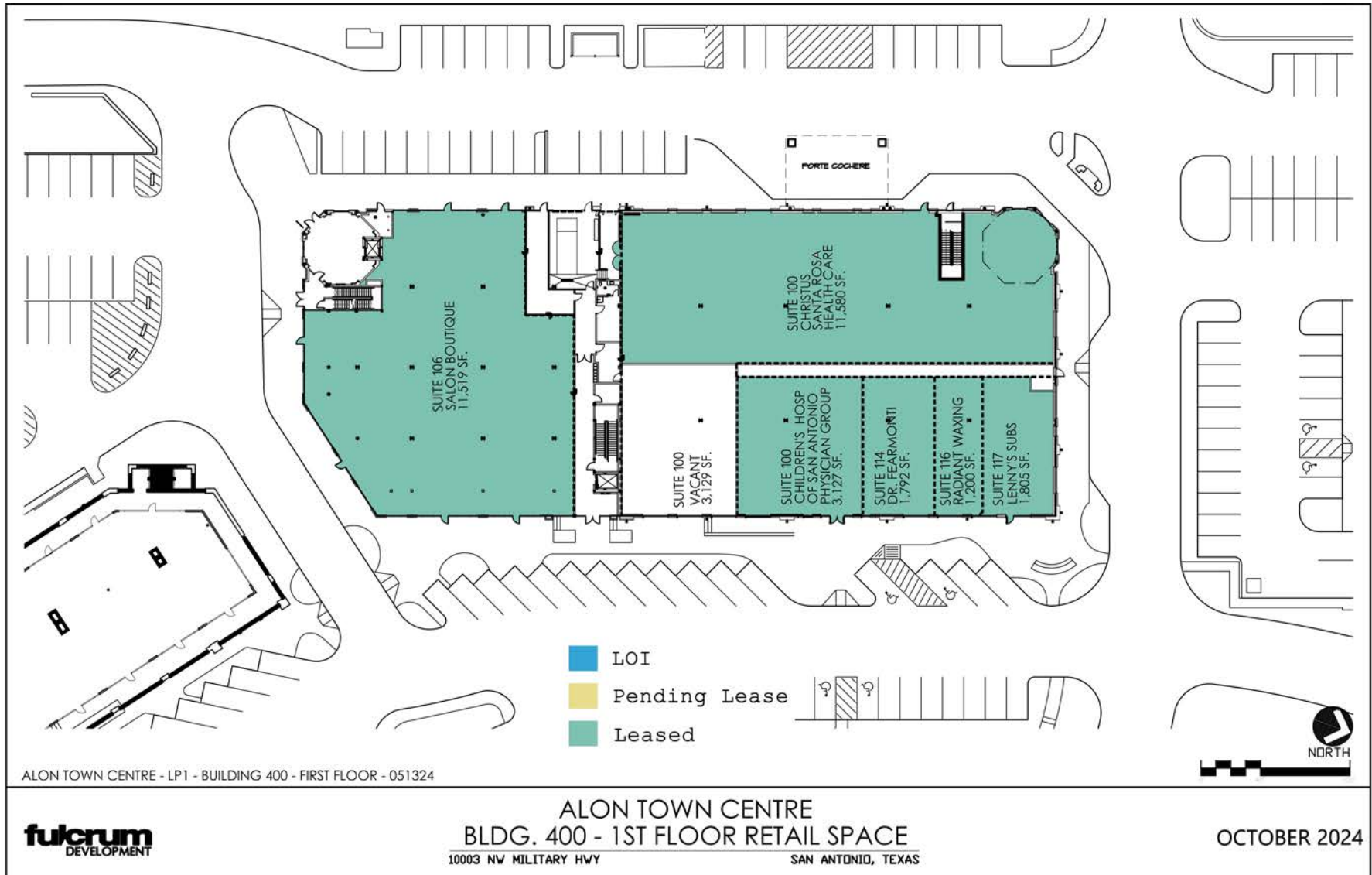

NOTE: THIS CONCEPTUAL SITE PLAN IS FOR MARKETING PURPOSES ONLY, & HAS BEEN PREPARED FOR CLIENT BASED UPON PRELIMINARY AVAILABLE SITE INFORMATION DEEMED RELIABLE. ALL DIMENSIONS, GRADES & AREA CALCULATIONS ARE SUBJECT TO VERIFICATION & MODIFICATION BY A PROFESSIONAL CIVIL ENGINEER FOR COMPLIANCE WITH ALL NATIONAL, STATE, & LOCAL REGULATIONS. NOT FOR REGULATORY APPROVAL, PERMITTING, OR CONSTRUCTION.

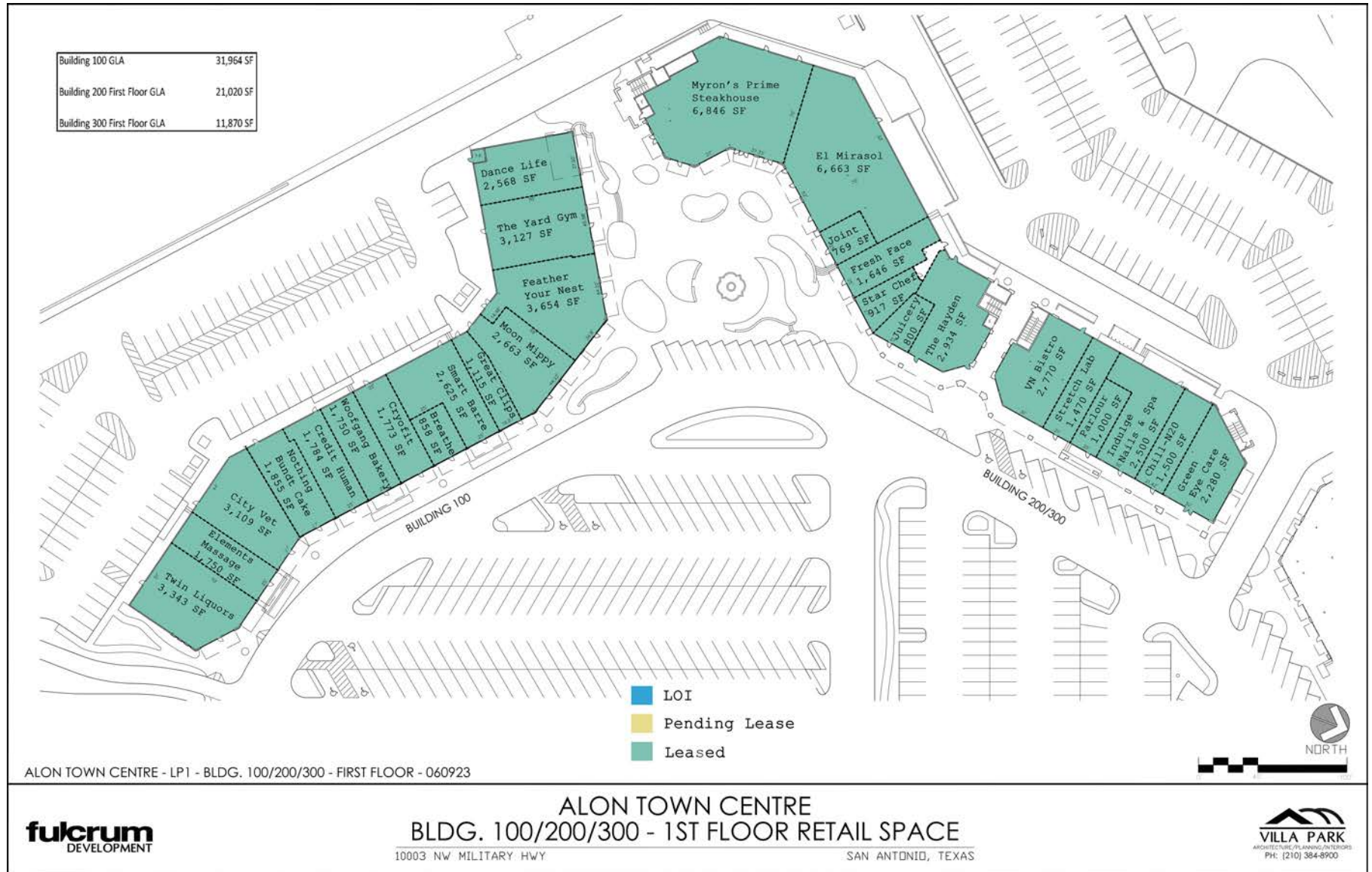

NOTE: THIS CONCEPTUAL SITE PLAN IS FOR MARKETING PURPOSES ONLY, & HAS BEEN PREPARED FOR CLIENT BASED UPON PRELIMINARY AVAILABLE SITE INFORMATION DEEMED RELIABLE. ALL DIMENSIONS, GRADES & AREA CALCULATIONS ARE SUBJECT TO VERIFICATION & MODIFICATION BY A PROFESSIONAL CIVIL ENGINEER FOR COMPLIANCE WITH ALL NATIONAL, STATE, & LOCAL REGULATIONS. NOT FOR REGULATORY APPROVAL, PERMITTING, OR CONSTRUCTION.

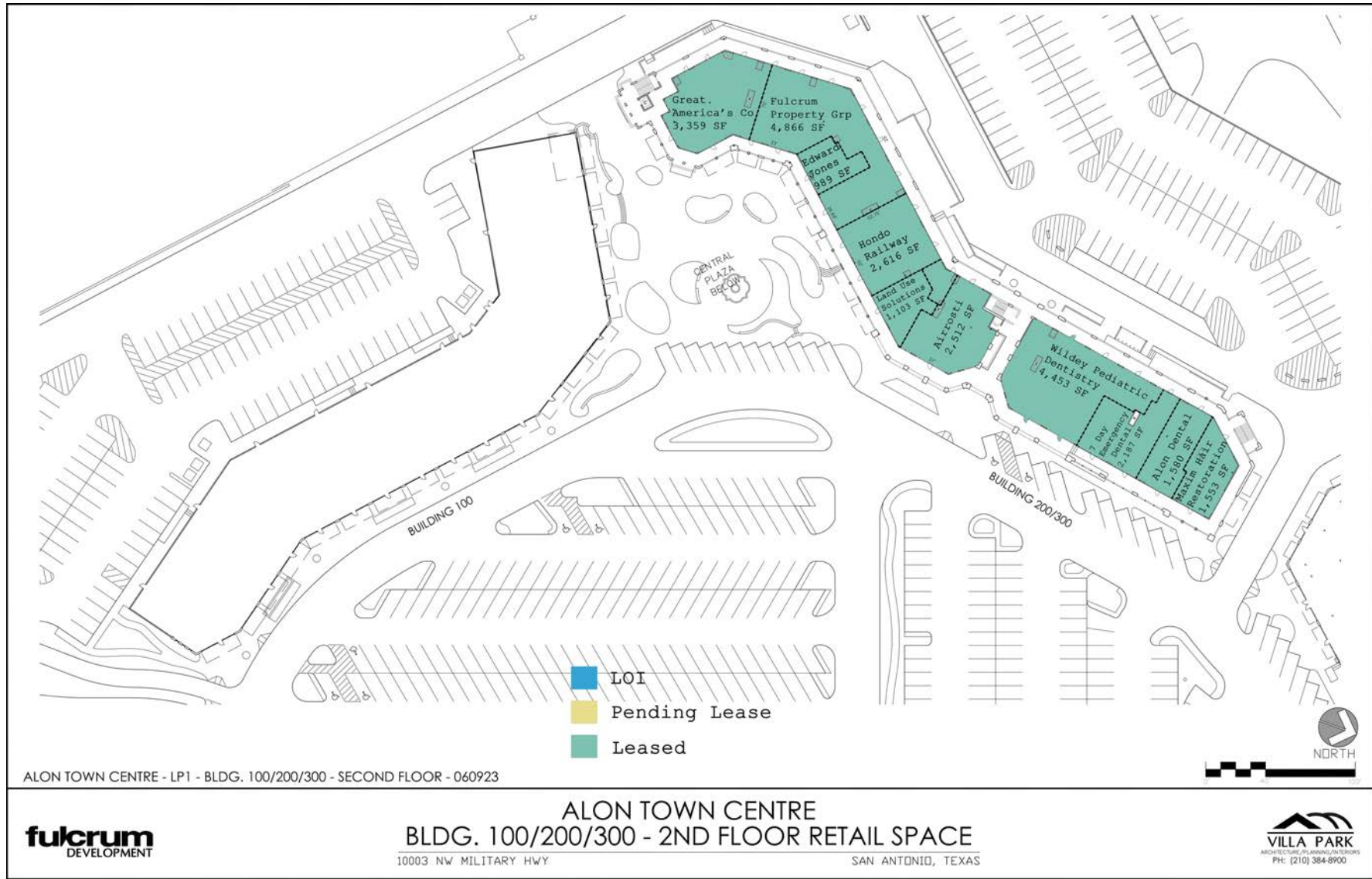

Alon Town Centre

Shopping Center Pictures



10003 NW Military Hwy, Suite #2205
San Antonio, TX 78231

t 210.593.0777
f 210.593.0780

www.fulcrumsa.com

fulcrum
DEVELOPMENT

